

Honeywell

V2 - KOMBI - GP16

Balancing Valve

PRODUCT SHEET

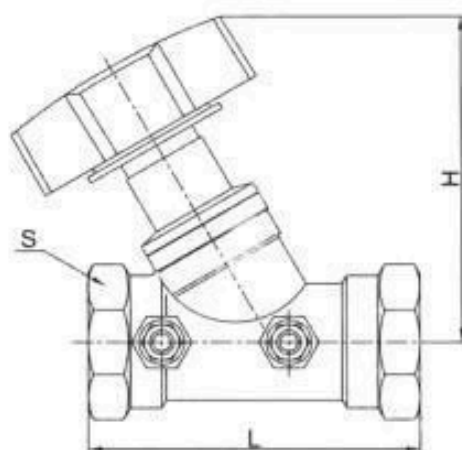

Figure 1.

Application

The hydronic balance is a significant requirement for the efficient operation of a hydronic heating or cooling installation. In an unbalanced system under or over provision of hot water /chilled water to individual radiators or circuits can occur. Apart from the correct selection of balancing valves, regulation of individual circuits is also necessary. This requirement is met with the shutoff and balancing valve, pre-setting, regulation & draining.

Features

- Handwheel and pre-setting dial and display
- Body and Bonnet are forged in brass.
- Valve insert made of brass with seat sealing made of PTFE
- Handwheel, pre-setting dial and display made of plastic.
- Flow direction is in direction of arrow on housing or body.
- Pipe thread to ISO7.
- Pressure rating: 300 psi non-shock.
- High accuracy of pre-setting because of individual adjustment
- Maximum Flow Temperature: 80°C(176°F)

Dimensions

DN	L	H	S
20	85	94	34
25	95	98	40
32	95	108	48
40	110	113	55
50	125	118	66